

SP-540V SP-300V

Before installing, be sure to read this.

This document describes important matters related to installation operations. When installing, be sure to read this document as well as the *Setup Guide*.

The procedures for "Filling with Ink for the First Time" have changed.

Some of what is described in the *Setup Guide* has changed. The procedure for installing ink cartridges for the first time after purchase has changed.

- Use the contents of this document instead of the procedures described on pages 27 to 29 of the *Setup Guide*.
- Careful attention is required, because performing the procedure incorrectly may result in malfunction or dot drop-out.
- When filling with ink, use the included dummy cartridges.

Dummy cartridges are included.

Dummy cartridges have been added to the included items. You use them when filling with ink. These are also required when moving the machine to a different location, so store them safely, without discarding them.

Important Note When Moving the Machine

When moving the machine to a different location, ink-filling must be performed again. The dummy cartridges are needed at this time. Store them safely, without discarding them. The procedure for moving the machine is described in the *Setup Guide*. Note, however, that the ink-filling performed at such times must also be carried out as explained in this document.

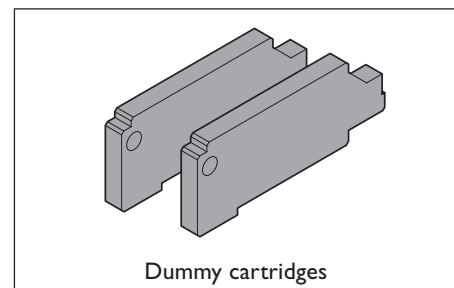

Replace pages 27 through 29 of the Setup Guide with this page.

1. Switch on the power and make the initial settings.

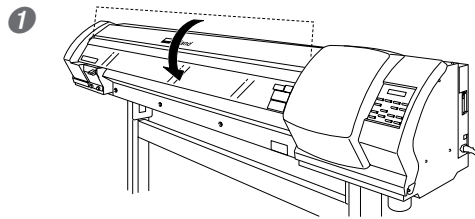

Close the front cover.

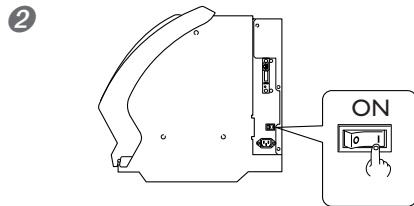

Switch on the main power switch.

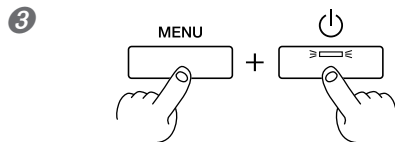

Hold down **MENU** and press the sub power switch.



Use **▲** **▼** to select the language you want.
Press **ENTER**.



Use **▲** **▼** to select the unit of measurement you want (for length).
Press **ENTER**.



Use **▲** **▼** to select the unit of measurement you want (for temperature).
Press **ENTER**.



Make sure the two voltage switches are set correctly.
Press **ENTER**.

2. Clean the heads using the cleaning cartridges.



① Use **▲** **▼** to select the ink type.
② Press **ENTER** to enable the selection.



① Make sure the drain bottle is installed.
② Press **ENTER**.



Flashing

Insert cleaning cartridges into slots 1 and 2.

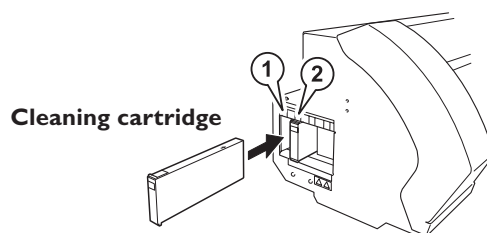

Replace pages 27 through 29 of the Setup Guide with this page.

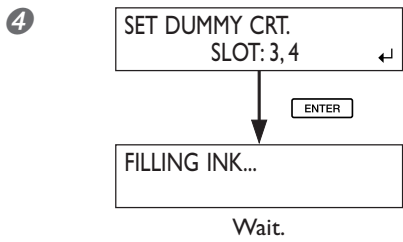

- ① Insert the dummy cartridges into slots 3 and 4.
- ② Press **ENTER** .

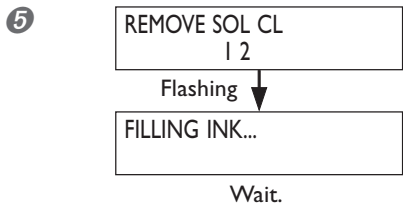
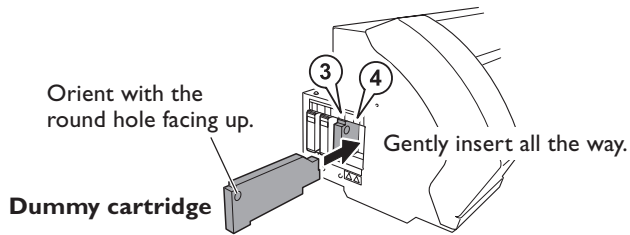

Pull out the cleaning cartridges from slots 1 and 2.

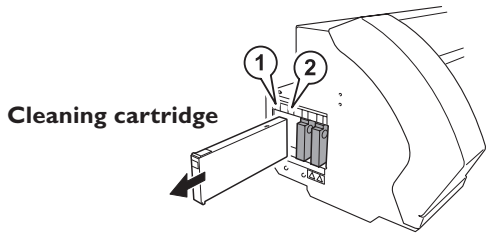

- ① Pull out the dummy cartridges from slots 3 and 4.
- ② Press **ENTER** .

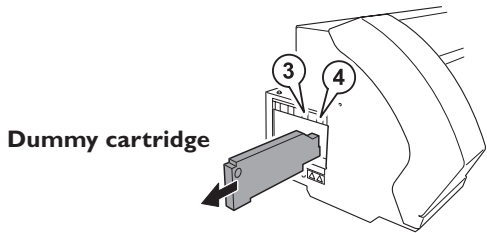

Insert the cleaning cartridges into slots 3 and 4.

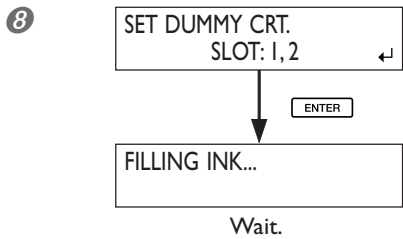
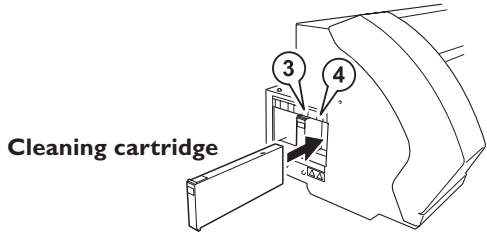

- ① Insert the dummy cartridges into slots 1 and 2.
- ② Press **ENTER** .

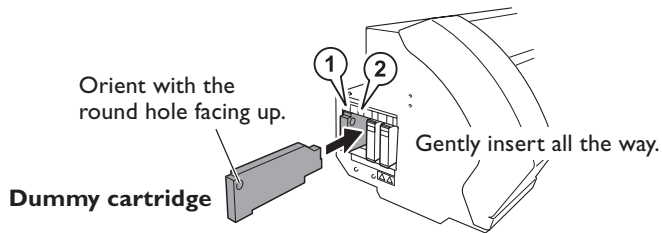

Replace pages 27 through 29 of the Setup Guide with this page.

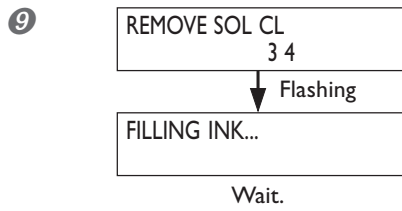

Pull out the cleaning cartridges from slots 3 and 4.

Cleaning cartridge

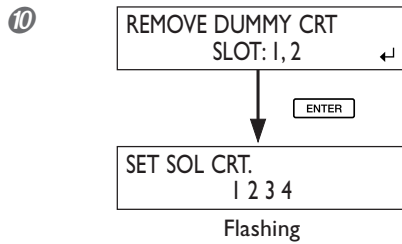
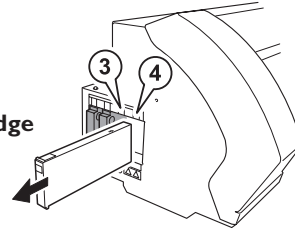

- ① Pull out the dummy cartridges from slots 1 and 2.
- ② Press **ENTER**.

Dummy cartridge

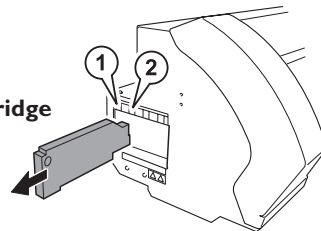

3. Insert the ink cartridges for the respective colors.

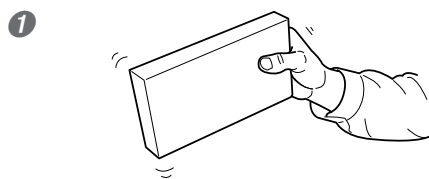

Before you insert the ink cartridge for each color, gently shake the cartridge.

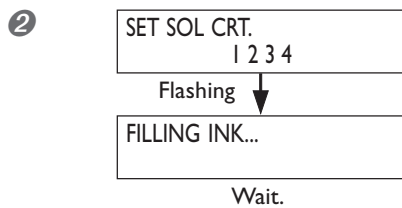

Insert the ink cartridge for each color.

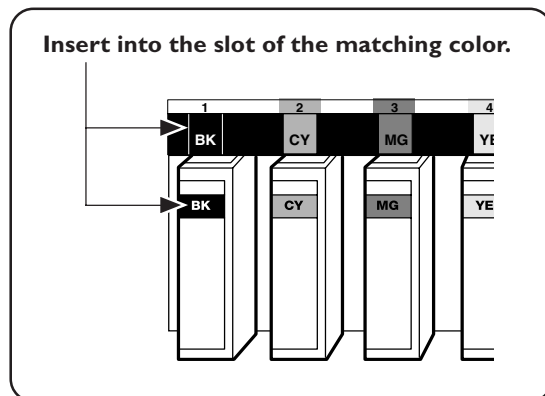
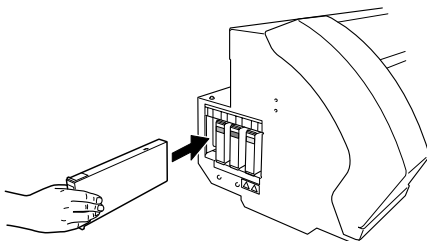

When the screen in the figure appears, ink filling ends.

