

# **ZMA2-53DC**

## **Using the Open Edge Adapter**

- 
- 
- To ensure safe use with a full understanding of this machine's performance, please be sure to read through this manual completely.
  - Store this manual in a safe place where it can be referred to when needed.
  - Reproduction, citation, or translation, in whole or in part, of this manual is prohibited without the express written consent of DGSHAPE Corporation.
  - The contents of this operation manual and the specifications of this product are subject to change without notice.
  - DGSHAPE Corporation assumes no responsibility for any damage that may occur through use of this product, regardless of any failure to perform on the part of this product or of any errors in this document. Damage includes but is not limited to damage caused by the specifications or performance of the product, damage caused by non-use of the product, and damage caused by deliverables obtained through use of this product. Such damage can be either direct or indirect.
- 
-

Company names and product names are trademarks or registered trademarks of their respective holders.

Copyright © 2022 DGSHAPE Corporation

<http://www.dgshape.com/>

# Contents

---

<b>Contents</b> .....	<b>1</b>
<b>Using the Open Edge Adapter</b> .....	<b>2</b>
What This Document Assumes.....	2
Included Items .....	2
Items to Prepare Yourself .....	2
Usage Method .....	3

# Using the Open Edge Adapter

## What This Document Assumes

- This document describes how to use the open edge adapter.
- Refer to the milling machine User's Manual for information such as important notes and basic usage guidelines for using the open edge adapter.

## Included Items

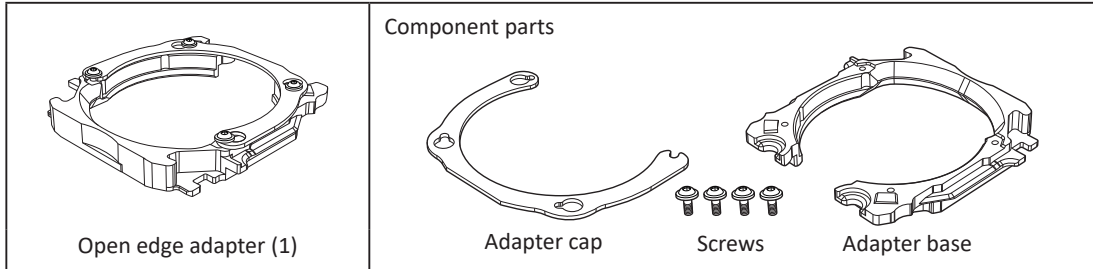

## Items to Prepare Yourself

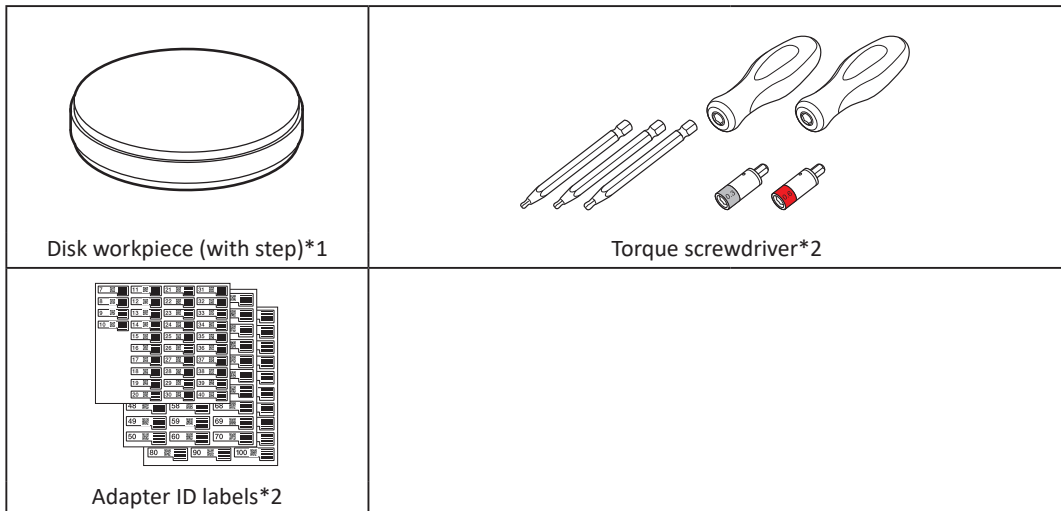

\*1: Workpiece size

Step section: 98.5 mm (3.88 in.) (diameter), 10 mm  $\pm$  0.3 mm (0.39 in.  $\pm$  0.01 in.) (height)

Body section: 95 mm (3.74 in.) (diameter), 35 mm (1.37 in.) max. (height)

\*2: Item included with the machine

## Usage Method

- 1 Use a torque screwdriver to loosen the adapter screws (in four locations), turning them approximately four times.

### MEMO

To improve the efficiency of the work and to prevent the loss of the screws, it is not necessary to remove the screws from the open edge adapter.

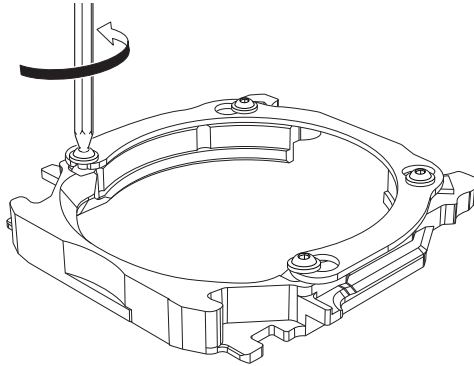

- 2 Remove the adapter cap.

- 1 Turn the adapter cap in the direction of the arrows.

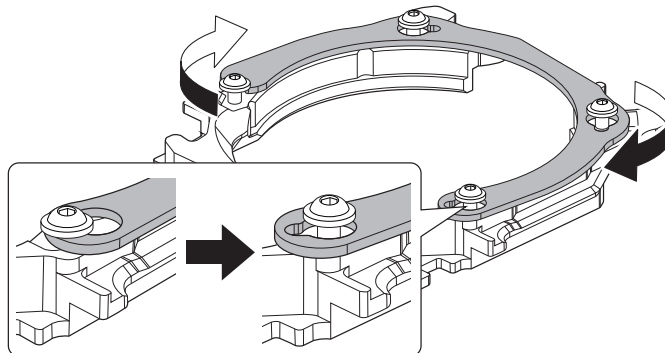

- 2 Lift up the adapter cap to remove it.

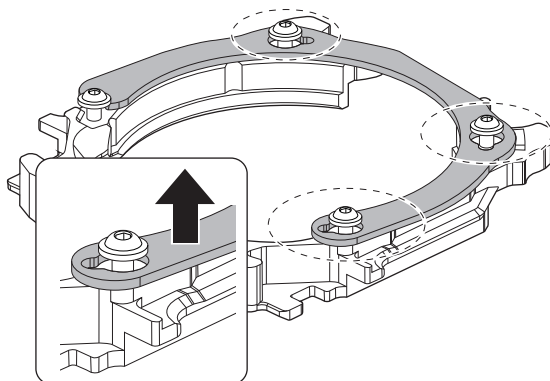

- 3 Set a disk workpiece in the open edge adapter.

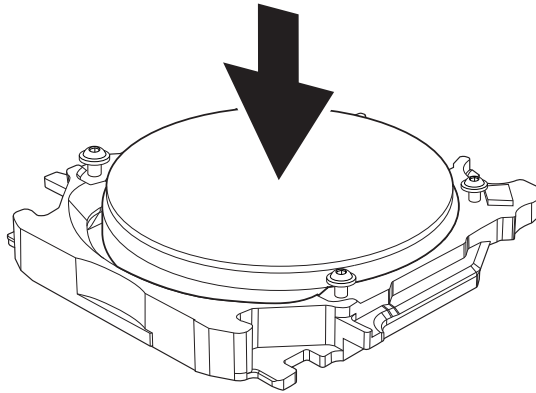

- 4 Attach the adapter cap.

- 1 Orient the adapter cap removed in step 2 as shown in the following figure.

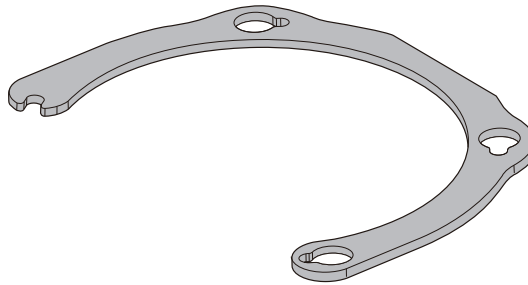

- 2 Attach the adapter cap as shown in the figure.

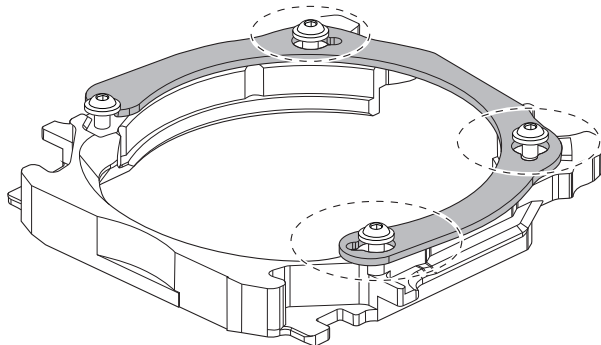

- ③ Turn the adapter cap in the direction of the arrows.

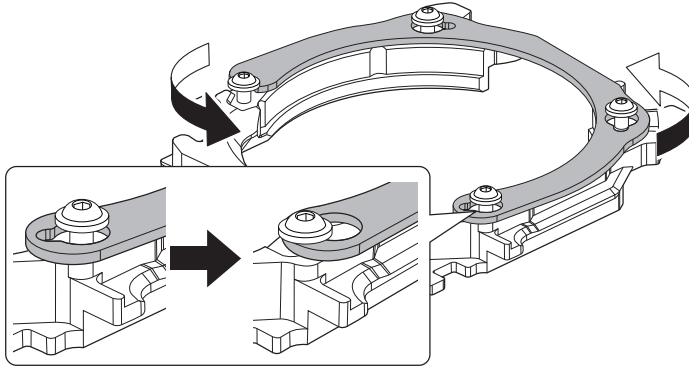

- ④ Temporarily tighten the screws.

Temporarily tighten the screws (in four locations) so that their seats come into contact with the adapter cap.

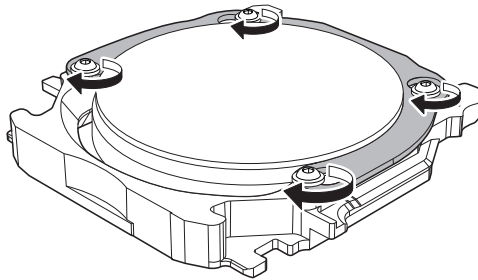

- ⑤ Check the material of the workpiece attached to the adapter, and then attach the sleeve and bit to the torque screwdriver.

**Important**

The screw tightening torque varies depending on the material of the attached workpiece.

**Workpiece material that requires the use of the 0.3 N·m, black sleeve**

Zirconia, wax, CoCr sintered metal, and gypsum

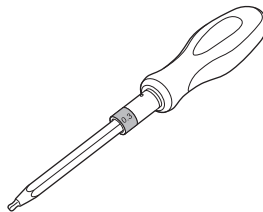

**Workpiece material that requires the use of the 0.6 N·m, red sleeve**

PMMA, composite resin, PEEK, PEKK, and glass-fiber-reinforced resin

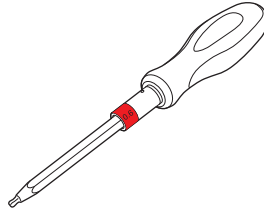

⑥ **Fully tighten the screws across the diagonals in the order of (1), (2), (3), (4).**

When the prescribed tightening torque is reached, turning the handle of the torque screwdriver no longer turns the screw bit. Tighten the screws until this state is reached.

**Important**

To prevent disk workpiece damage, follow the precautions listed below.

- Use the torque screwdriver included with the machine to tighten the screws.
- Be sure to tighten the screws across the diagonals.

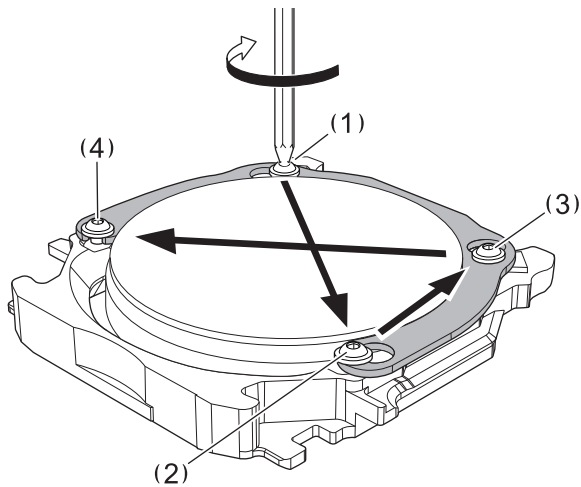

⑤ **Attach an adapter ID label to the adapter base.**

**MEMO**

You can use an adapter ID label with any number.

